

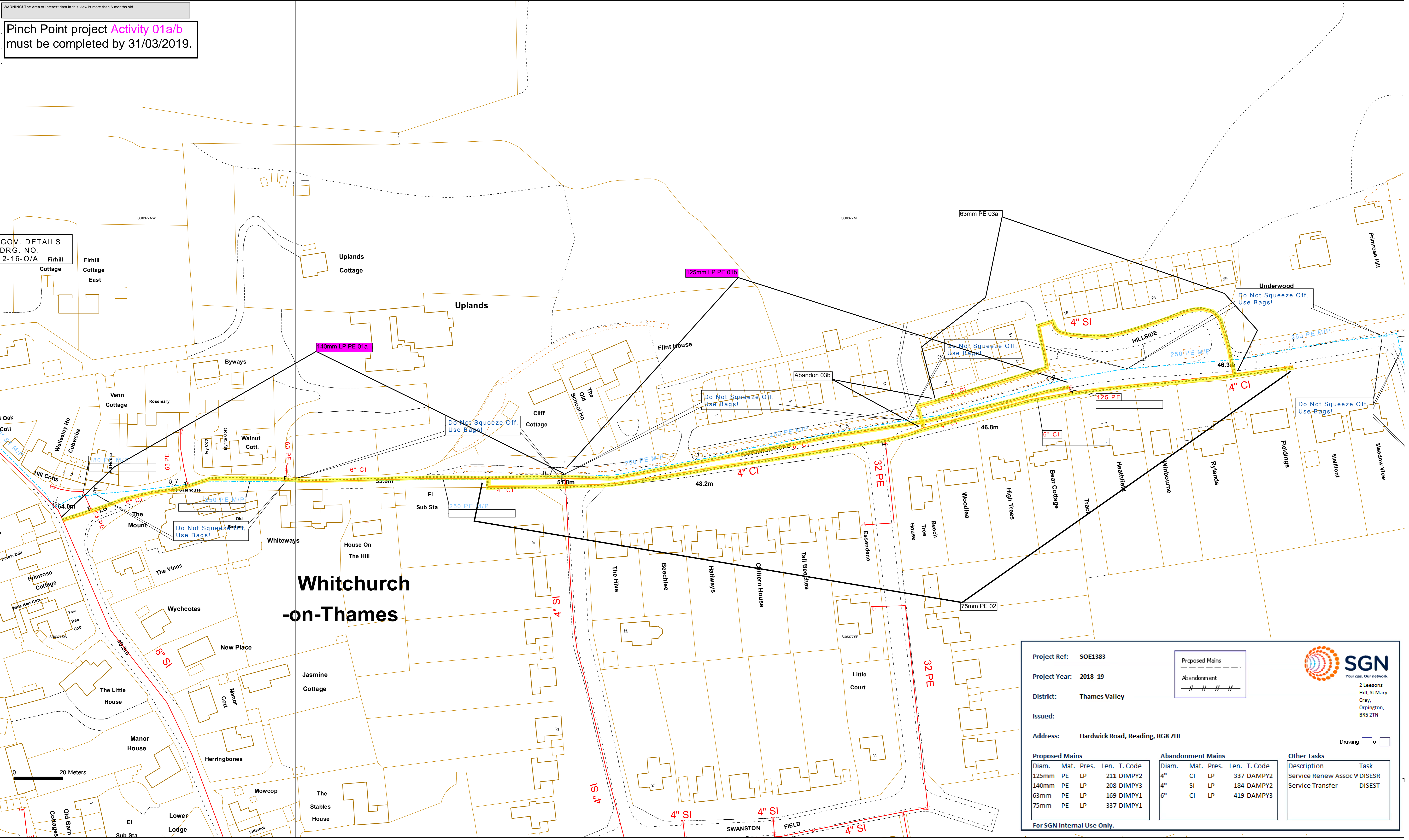

WARNING! The Area of Interest data in this view is more than 6 months old.

Pinch Point project Activity 01a/b must be completed by 31/03/2019.

GOV. DETAILS
DRG. NO.
12-16-O/A



Whitchurch-on-Thames

Project Ref:	SOE1383	 <p>SGN Your gas. Our network. 2 Leasons Hill, St Mary Cray, Orpington, BR5 2TN</p>
Project Year:	2018_19	
District:	Thames Valley	Drawing <input type="checkbox"/> of <input type="checkbox"/>
Issued:		
Address:	Hardwick Road, Reading, RG8 7HL	

Proposed Mains				Abandonment Mains				Other Tasks			
Diam.	Mat.	Pres.	Len.	T. Code	Diam.	Mat.	Pres.	Len.	T. Code	Description	Task
125mm	PE	LP	211	DIMPY2	4"	CI	LP	337	DAMPY2	Service Renew Assoc V	DISESR
140mm	PE	LP	208	DIMPY3	4"	SI	LP	184	DAMPY2	Service Transfer	DISEST
63mm	PE	LP	169	DIMPY1	6"	CI	LP	419	DAMPY3		
75mm	PE	LP	337	DIMPY1							

For SGN Internal Use Only.

SCALE 1: 500

USER ID: pf29909

DATE: 24/08/2017

INTERNAL USE ONLY

GRID REFERENCE:
E463665,N177507,SU 63 77

Some examples of Plant items:

Valve	⊗	Depth	∨	Syphon	○	Diameter Change	⊥	Material Change	
-------	---	-------	---	--------	---	-----------------	---	-----------------	--

LP MAINS	—
MP MAINS	- - -
IP MAINS	- · - · -
LHP MAINS	- · - · - · -
HISTORY DATA	—
LAs	—
GTs	■
SSSIs	■

This plan shows the location of those pipes owned by Scotia Gas Networks (SGN) by virtue of being a licensed Gas Transporter (GT). Gas pipes owned by other GTs or third parties may also be present in this area but are not shown on this plan. Information with regard to such pipes should be obtained from the relevant owners. No warranties are given with regard to the accuracy of the information shown on this plan. Service pipes, valves, siphons, sub-connections etc are not shown but their presence should be anticipated. You should be aware that a small percentage of our pipes/assets may be undergoing review and will temporarily be highlighted in yellow. If your proposed works are close to one of these pipes, you should contact the SGN Plant Protection Team on 08450703497 for advice. No liability of any kind whatsoever is accepted by SGN or its agents, servants or sub-contractors for any error or omission contained herein. Safe digging practices, in accordance with HS (G)47, must be used to verify and establish the actual position of mains, pipes, services and other apparatus on site before any mechanical plant is used. It is your responsibility to ensure that plant location information is provided to all persons (whether direct labour or sub-contractors) working for you on or near gas apparatus. Information included on this plan should not be referred to beyond a period of 28 days from the date of issue.

INTRANET MAP VERSION 2.1

Oxfordshire County Area

This plan is reproduced from or based on the OS map by Scotia Gas Networks plc, with the sanction of the controller of HM Stationery Office. Crown Copyright Reserved.

